



# Raxil<sup>®</sup> PRO SHIELD



**NEW** Raxil<sup>®</sup> PRO SHIELD all-in-one seed treatment brings the trusted performance of the #1 selling cereal seed treatment brand in Western Canada<sup>1</sup> with the power of disease and insect protection, and no additional mixing required. Raxil PRO SHIELD all-in-one maintains the market-leading formulation of Raxil PRO but with enhanced coverage, a deeper red colour on your seed, minimal dust-off and buildup, and makes treating in cool conditions easier. Now, Raxil PRO SHIELD is available in a convenient co-formulated jug and an industry-leading bottom drain drum.

<sup>1</sup> 2022 BPI REPORT - CEREAL SEED TREATMENTS

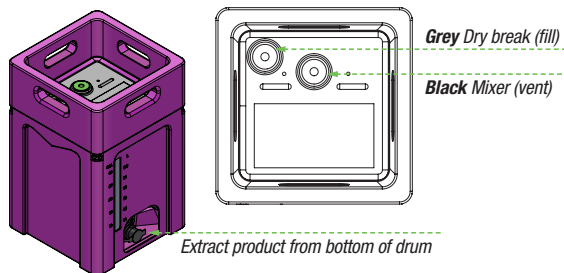

RATE
Raxil PRO SHIELD all-in-one: 325 mL/100 kg of seed
MIXING INSTRUCTIONS
Designed for maximum coverage, this 140 L drum containing 125 L of Raxil PRO SHIELD is fully compatible with your existing mixing equipment. Before use, all wire holding caps can be cut for easy access (seed treatment containers only).
<b>A: Mixer/vent</b> Bung A is for agitation of Raxil PRO SHIELD before product use, but only if pump recirculation is not an option. To mix: remove only the middle portion of Bung A. Attach the mixing drill bit found attached to the top of the drum to a standard electric drill (not an impact drill). Engage the drill-mounted bit to the square shaft of the mixer. Mix at 450-500 rpm for one minute. Do not apply pressure. *Caution: Higher speeds or mixing too long may weaken the integrity of the mixer and product.
<b>B: Grey dry break filling valve</b> Bung B is for the addition of product if required. Product can be pumped into the container using a Parker female dry break coupler provided on top of the drum. Product CANNOT be extracted from this bung.
<b>C: Bottom dry break extraction/recirculation ball valve</b> Bung C is for extracting product from the drum. Attach a pump using a Parker female dry break coupler provided in the valve housing to Bung C to meter the product from the container to the applicator. If recirculating, extract from Bung C and return to Bung B using both dry break fittings. To Vent Drum: remove only the middle portion of Bung A.



Tebuconazole  
Prothioconazole  
Group 3

SEED TREATMENT



Imidacloprid  
Metalaxyl  
Group 4

Contact + Systemic  
Protection

## THE RAXIL PRO SHIELD ADVANTAGE

### RAXIL PRO + STRESS SHIELD = RAXIL PRO SHIELD

- Unmatched seed- and soil-borne disease control, including best-in-class protection from *Fusarium graminearum* and true loose smut
- One simple rate, regardless of disease pressure, with no need for additional mixing
- Three fungicidal actives offer both contact and systemic protection
- The active ingredient in Stress Shield<sup>®</sup>, imidacloprid, prevents pests like wireworms from feeding on cereal crops
- Helps ensure uniformity in your fields, which makes timing a herbicide or fungicide application easier

PEST	BARLEY	OATS	WHEAT
BARLEY LEAF STRIPE	C		
COMMON BUNT			C
COMMON ROOT ROT	S	S	S
COVERED SMUT	C	C	
FALSE LOOSE SMUT	C		
LOOSE SMUT		C	
PRE-EMERGENT DAMPING-OFF	C/S	C/S	C/S
POST-EMERGENT DAMPING-OFF	C	C	C
RHIZOCTONIA SOLANI	S	S	S
ROOT AND CROWN ROT	S	S	S
SEEDLING BLIGHT	C/S	C/S	C/S
SEED ROT	C/S	C/S	C/S
TRUE LOOSE SMUT	C		
WIREWORMS	Protected from wireworms in all crops		

C = Control      S = Suppression

For full details please reference product label

## SEED TREATMENT FLOWABILITY COMPARISON OF COLD AND WARM SEED

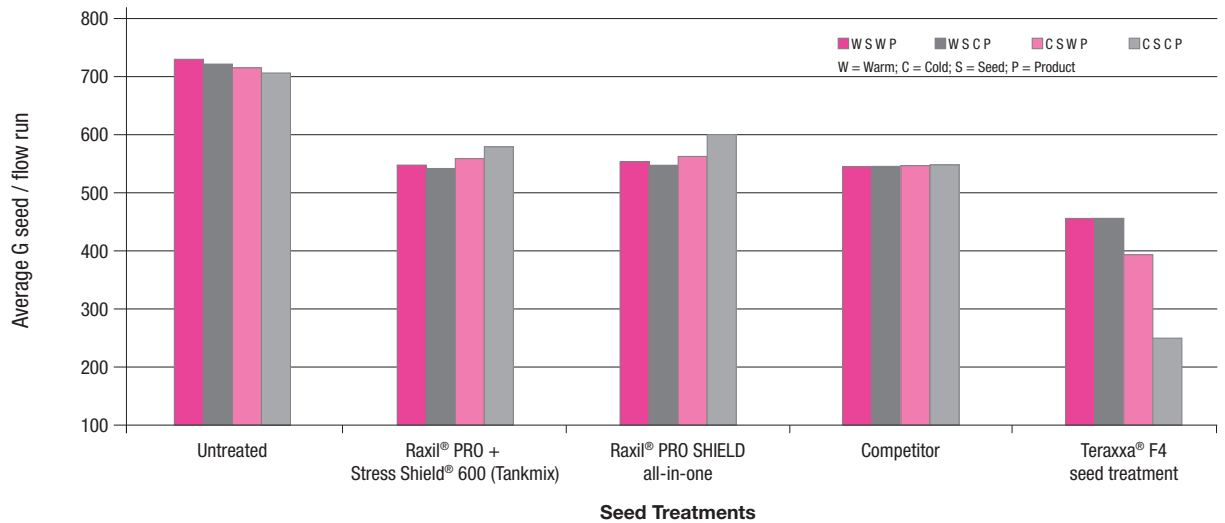

Source: 3 Bayer Crop Science internal lab-based trials (Saskatoon, 2021).  
Your results may vary according to agronomic, environmental and pest pressure variables.

## SEED TREATMENT DUST-OFF COMPARISON

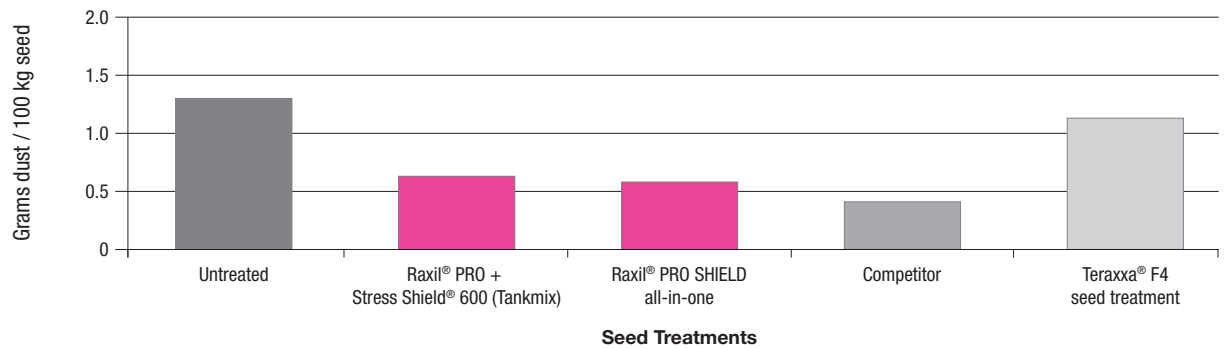

Source: 12 Bayer Crop Science internal lab-based trials (Saskatoon, 2021).  
Your results may vary according to agronomic, environmental and pest pressure variables.

## RAXIL PRO SHIELD ALL-IN-ONE - BUSHEL TREATED

BARLEY			OATS			WHEAT		
LB/BU.	bu. treated per 10 L jug	bu. treated per 125 L drum	LB/BU.	bu. treated per 10 L jug	bu. treated per 125 L drum	LB/BU.	bu. treated per 10 L jug	bu. treated per 125 L drum
48	141	1,766	34	200	2,494	60	113	1,413
50	136	1,696	36	188	2,355	62	109	1,368
52	130	1,631	38	179	2,231	64	106	1,325
54	126	1,570	40	170	2,120	66	103	1,285
56	121	1,514	42	162	2,019	68	100	1,247
58	117	1,462	44	154	1,927	70	97	1,211



[croppscience.bayer.ca/RaxilPROShield](https://croppscience.bayer.ca/RaxilPROShield) | 1 888-283-6847 | [@Bayer4CropsCA](https://twitter.com/Bayer4CropsCA) | #AskBayerCrop

C-72-11/18-11054305-E